

Custom - Made Roller Blind Installation Instructions

TOOL CHECKLIST REQUIRED:

Drill (with 4.9mm drill bit)	Measuring Tape	Ruler
Screwdriver	Pencil	Step Ladder

This blind is supplied with a colour co-ordinated valance, bottom rail and accessories

Hanging your blind

Using the universal brackets supplied, you can install your blind in one of two mounting positions:

1. Wall face mount (on the wall above the window) using the rear holes.
2. Window recess or ceiling mount using the side or top holes.

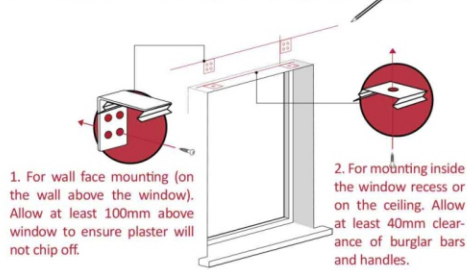

1. For wall face mounting (on the wall above the window). Allow at least 100mm above window to ensure plaster will not chip off.

2. For mounting inside the window recess or on the ceiling. Allow at least 40mm clearance of burglar bars and handles.

1 Position the blind

Hold the headrail up to the window where you want to mount the blind. Make a pencil mark onto the wall/surface 50mm in from the end of each of the headrail. Place a bracket onto each pencil mark and mark the bracket holes onto the wall/surface with a pencil. Any other brackets should be evenly spaced between these brackets.

2 Drill the holes and attach brackets

Concrete or Brick: Drill holes where you marked the bracket holes, using a 4.9mm masonry bit and insert wall plugs provided. Place bracket over holes and screw tight with screws provided into the wall plugs.

Wood: Drill holes where you marked the bracket holes, using a 4.9mm steel bit. Place bracket over holes and screw tight with screws provided.

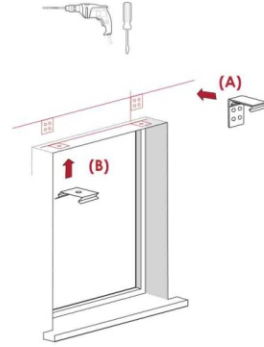

Clip the front of the headrail up into the front of the brackets and then click the back of the headrail in place.

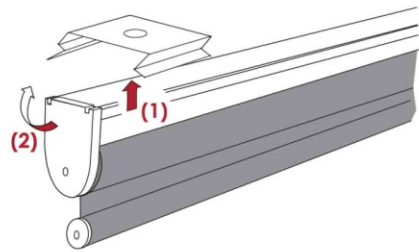

3 Attach the headrail

Clip the headrail in position.

4 Preparing your blind

Carefully unwind the beaded chain and the blind is ready for use.

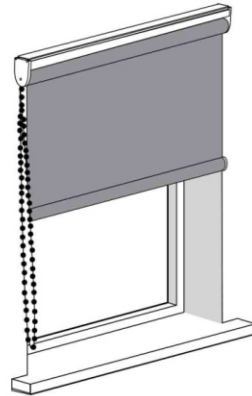

Custom - Made Roller Blind Installation Instructions

Operating your blind

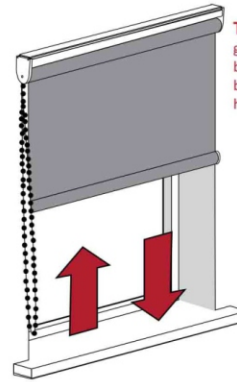

To lower the blind gently pull on one of the beaded chains until the blind reaches the desired height

To raise the blind gently pull on one of the beaded chains until the blind reaches the desired height. Do not pull the beaded chain too far, forcing the stopper into the gear unit. It will damage the blind.

Cleaning your blind



Periodic dusting is recommended. Use the vacuum cleaner upholstery brush attachment to gently vacuum clean. Be careful not to suck onto the blind surface as this may cause damage.

WARNING: Strangulation Hazard

Never put a crib or child's bed near a window. Even if you have child's guards on the window, the temptation to investigate from a hanging window covering is strong for a child

Because young children climb, never put furniture near a window with a dangling cord. Children climb on furniture, play with cords or chains and can become entangled.

To secure cords out of reach of children, use one of the suggested methods:

- A: Tie cord to itself.
- B: Use a cleat on wall or window frame.
- C: Use a clamp or clothes peg.

